

Larson Systems Inc.

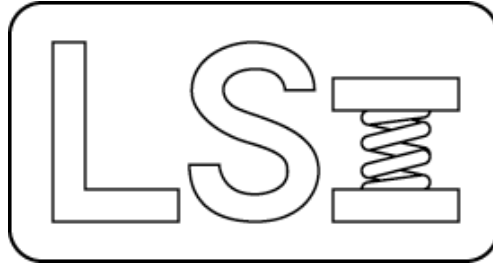

FLASH 25 Parts List

050-0000-0040-00 – 3,000 lb Whisper Drive

050-0000-0115-00 – 6,000 lb Whisper Drive





050-0000-0040-00 G

Parts List

FLASH 25 - 3,000 lb (12" Ø x 25" tall)

Rev	By	Date	Description
D	MDL	02-11-2003	Added 025-6000-0015-00 Sticker Assembly
E	KMP	10-19-2005	Update B-M to new layout
F	DAL	11-16-2009	delete #6 013-7000-0008-00, 060-1000-0066-00 was 060-0000-0029-00
G	DAL	03-28-2012	Update schematic was 025-2000-0090-01 and 025-2000-0090-02 is 025-2000-0165-07

Item	Qty	Part Number	Rev	Part Name	PCB Location	Part Length
1	1	025-0000-0266-01	J	Main Assembly FLASH 25-XXXX, Left Swing Door		in.
2	Ref	025-0000-0266-02		Main Assembly UT 25-XXXX, Right Swing Door		in.
3	Ref	025-0000-0266-03	E	Main Assembly UT 25-3000, (No Door)		in.
4	1	059-0000-0024-00		Shipping Crate - UT 25-2000		in.
5	1	060-1000-0066-00	E	User Manual - FLASH Series 11 & 24		in.
7	1	060-2000-0008-00		Parts List - FLASH 25		in.
8	1	025-6000-0015-00	C	Sticker Assembly - FLASH 25		in.
9	1	025-2000-0165-07	E	Schematic, Flash 25-X000, Attached computer 240		in.
9	1	060-6000-0114-00		FLASH : System Image Creation Letter		in.

Renamed to FLASH instead of UT. -MDL, 7-27-2006

Approved by: 

Date: March 28, 2012

SEE ATTACHED 2 DRAWINGS



050-0000-0115-00 A

Parts List

FLASH 25 - 6,000 lb (12" Ø x 25" tall)

Rev	By	Date	Description
	KMP	08-15-2006	
A	DAL	03-28-2012	Update schematic was 025-2000-0090-10 and 025-2000-0160-03 is 025-2000-0165-07

Item	Qty	Part Number	Rev	Part Name	PCB Location	Part Length
1	1	025-0000-0266-01	J	Main Assembly FLASH 25-XXXX, Left Swing Door		in.
2	Ref	025-0000-0266-02		Main Assembly UT 25-XXXX, Right Swing Door		in.
3	Ref	025-0000-0266-03	E	Main Assembly UT 25-3000, (No Door)		in.
4	1	059-0000-0024-00		Shipping Crate - UT 25-2000		in.
5	1	060-1000-0066-00	E	User Manual - FLASH Series 11 & 24		in.
7	1	060-2000-0008-00		Parts List - FLASH 25		in.
8	1	025-6000-0015-00	C	Sticker Assembly - FLASH 25		in.
9	1	025-2000-0165-07	E	Schematic, Flash 25-X000, Attached computer 240		in.
9	1	060-6000-0114-00		FLASH : System Image Creation Letter		in.

Renamed to FLASH instead of UT. -MDL, 7-27-2006

Approved by: 

Date: March 28, 2012

SEE ATTACHED 2 DRAWINGS

REV	DATE	DESCRIPTION	DRW	APP
		SEE SHEET 3		

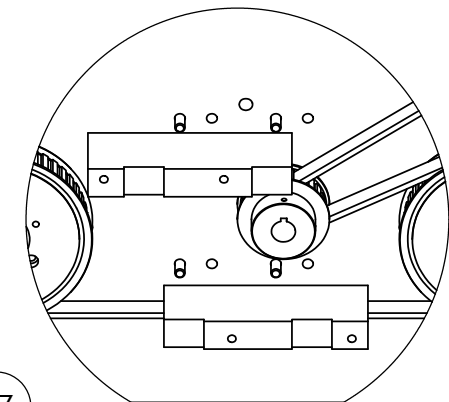
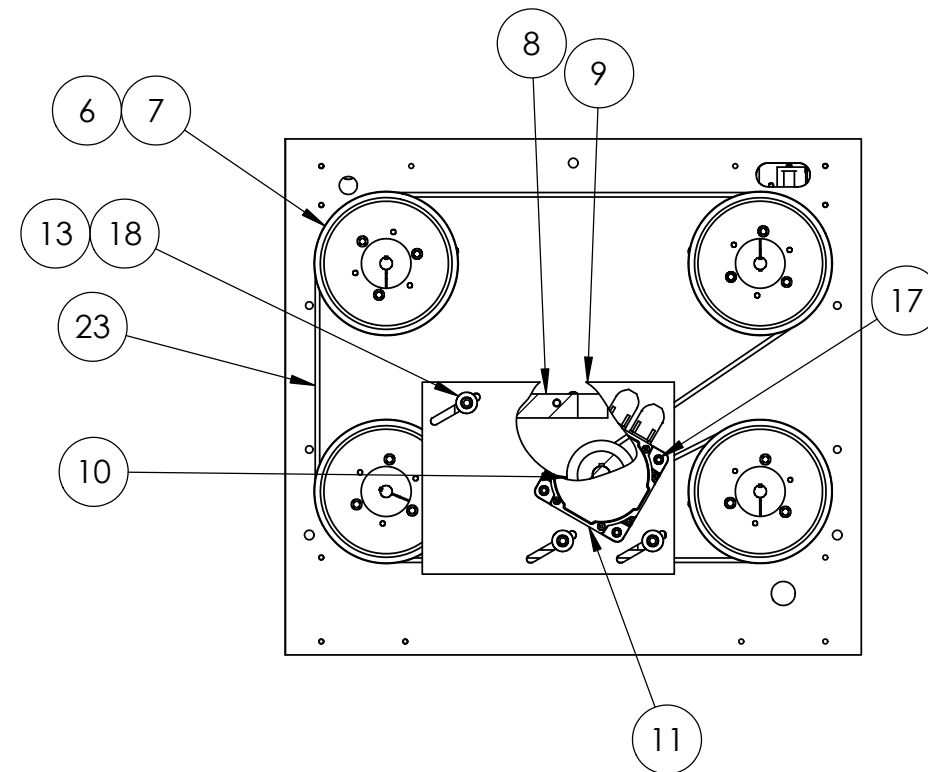
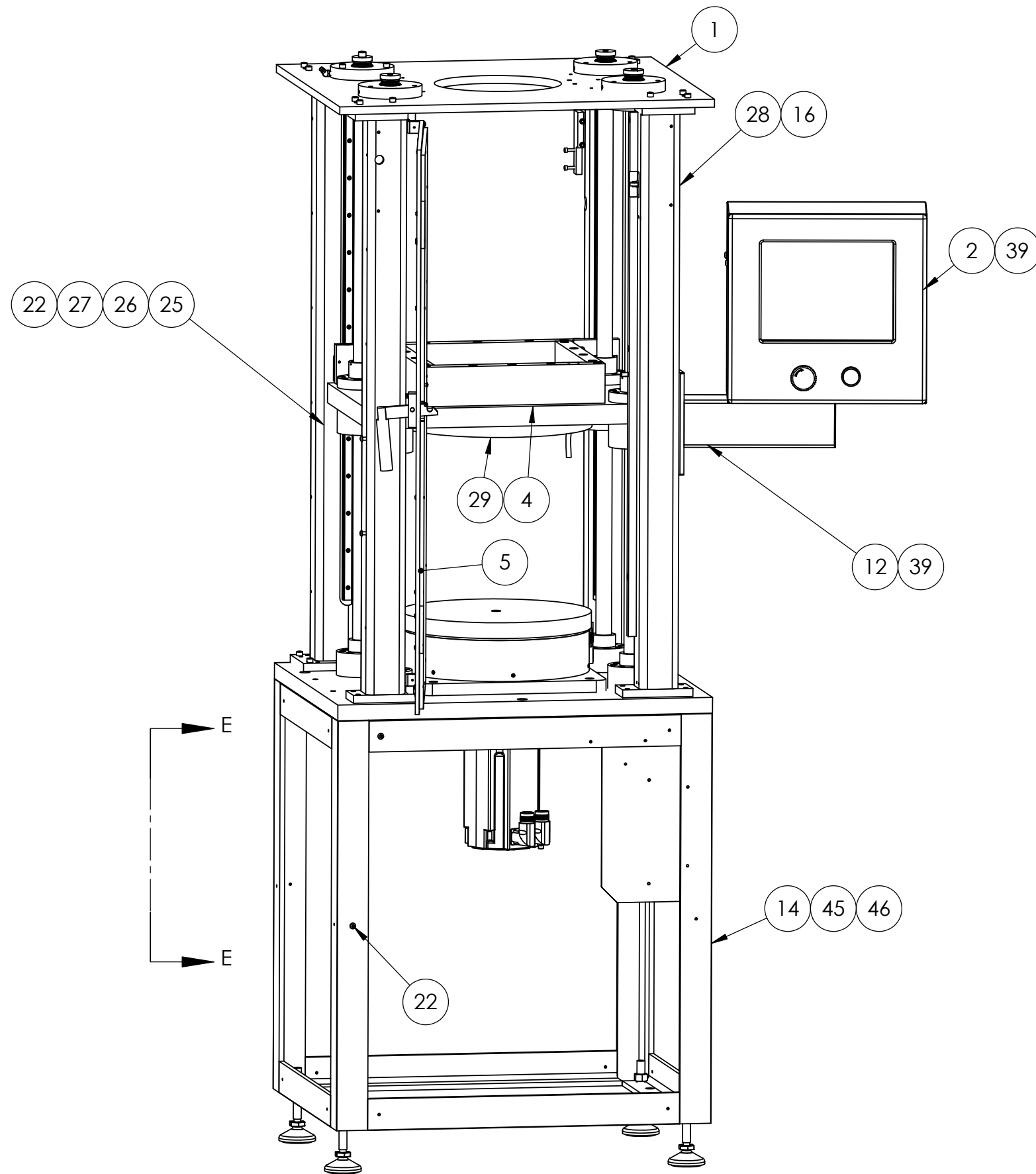

BOTTOM VIEW
DRIVE SYSTEM

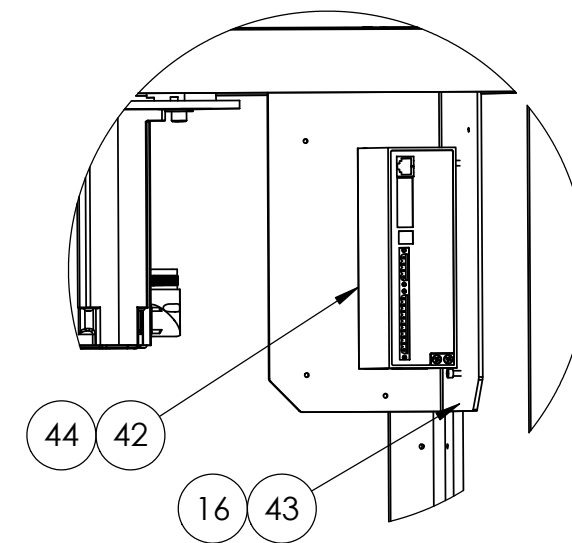

VIEW E - E

UNLESS OTHERWISE SPECIFIED
DIMENSIONS ARE IN INCHES
TOLERANCES ARE:
.XX ± .01
.XXX ± .005

MATERIAL	-
FINISH	-
HEAT TREAT	-



LARSON SYSTEMS INC.

10073 Baltimore St. NE PH. 763-780-2131
Mpls., MN 55449 FAX. 763-780-2182

APPROVALS	DATE
DRAWN KMP	10-20-05
APP.	
APP.	

MAIN ASSEMBLY UT 25 3000 - 6000
LEFT SWING DOOR

B DWG. NO. 025-0000-0266-01J

SCALE: NONE SHEET 1 OF 4

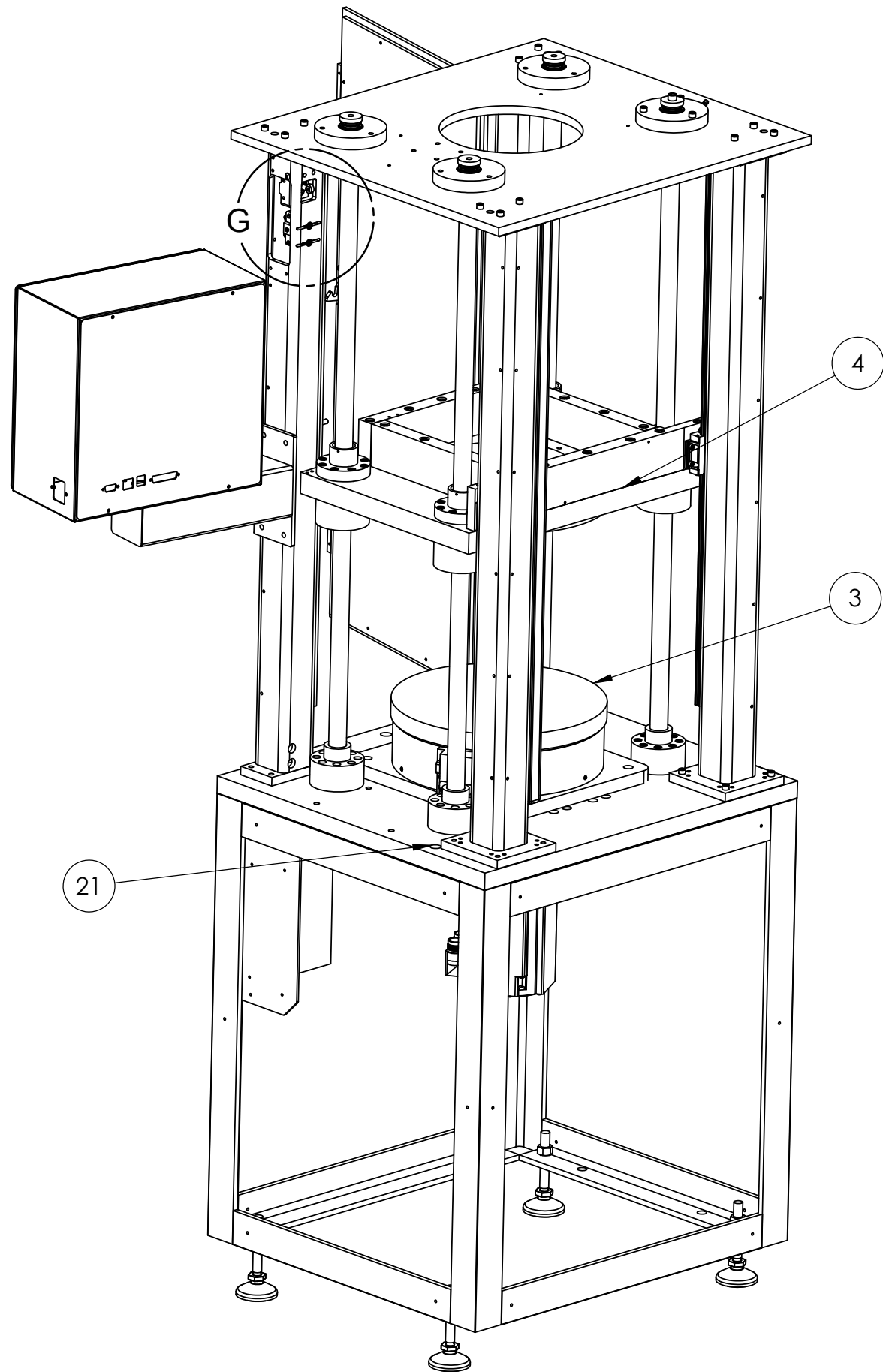

DETAIL G
SWITCHES

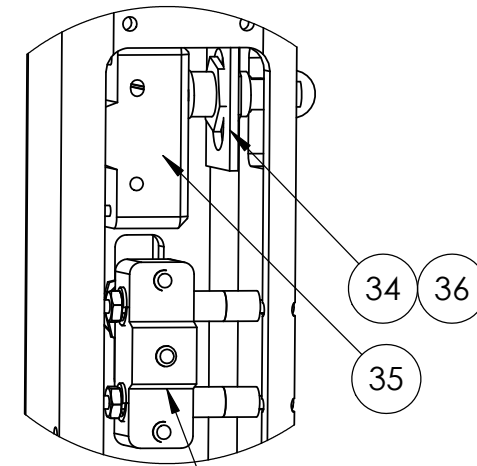

DOOR SWITCH
SEE ASSEMBLY
025-0000-0335-00

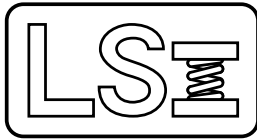

025-0000-0266-01 J

Parts List

Main Assembly UT 25-XXXX, Left Swing Door

Rev	By	Date	Description
F	KMP	02-16-2007	Change the belt winding dircetion, Update Motor Bracket and Stand-off, Items 21 was (12) 13-0-0065-00, 22 was (45), 34 was 18-0-2799-00, 35 was 7-0-0099-00, 36 was 13-0-0057-00, 42 was 11-3-0017-00, 43 was 25-1-0543-00.
G	MEL	02-11-2008	Added 050-1000-0047-00
H	SGS	06-16-2008	Chg Servo location and Belt Length
J	DAL	11-19-2009	Revised motor mount to accept 4X and 5X series motors, 018-000-3176-00 was 018-0000-1210-00

Item	Qty	Part Number	Rev	Part Name	PCB Location	Part Length
1	1	025-0000-0264-00	F	Upper Frame Assembly UT 25 3000 lb - 6000 lb		in.
2	1	025-0000-0431-10	B	FLASH - Computer Assembly		in.
3	Ref	025-0000-0262-00	E	FLASH 25 Interchangeable Load Cell - 3,000 lb		in.
3	Ref	025-0000-0262-06	E	FLASH 25 Interchangeable Load Cell - 6,000 lb		in.
4	1	025-0000-0683-00		Platform Assy, UT25		in.
5	1	025-0000-0335-00	E	DOOR ASSEMBLY, SWING, LH, UT-25		in.
6	4	013-5000-0081-00		Bushing Driven Pulley Keyed		in.
7	4	013-5000-0080-00		Driven Pulley, 48 Tooth		in.
8	2	018-0000-1209-00	D	MOTOR MTG. STANDOFFS,UT 25-2000		in.
9	1	018-0000-1210-00	E	MOTOR MTG. PLATE,Flash 25 series testers		in.
10	1	018-0000-1233-00		Motor Pulley, 12 Tooth		in.
10	Ref	018-0000-1233-01		Motor Pulley, 14 Tooth		in.
10	Ref	018-0000-1233-02		Motor Pulley, 16 Tooth		in.
10	Ref	018-0000-1233-03		Motor Pulley, 22 Tooth		in.
10	ref	013-5000-0233-00		Bushing 3/4 dia x 3/16 key		in.
10	ref	013-5000-0234-00		Pulley 32 tooth		in.
11	Ref	014-2000-0028-00		AKM41 SERVO MOTOR		in.
11	Ref	014-2000-0029-00		AKM43 SERVO MOTOR		in.
11	Ref	014-2000-0030-00		AKM53G SERVO MOTOR		in.
12	1	018-0000-1879-04	B	Support Arm Weldment		in.
13	4	013-0000-0083-00		5/16-18 X 1 SHCS		in.
14	1	018-0000-1185-00	G	Frame UT 25-0000		in.
15	Opt	011-4000-0018-00		Fan 5.0"- 115 VAC		in.
16	8	013-0000-0118-00		10-24 X 3/8 BHSCS		in.
17	4	013-0000-0137-00		10-24 X 3/4 SHCS		in.
17	Opt	013-0000-0182-00		1/4-28 X 5/8 SHCS		in.
18	4	013-2000-0202-00		Thrust Washer, 3/8 x 13/16 x .093		in.
19	Opt	013-0000-0059-00		8-32 X 2 1/4 SHCS		in.
20	Opt	013-0000-0437-00		8-32 Flange Lock Nut		in.
21	3	013-0000-0167-00		3/8-16 X 1 SHCS		in.

#10 AKM41 Motor, 16:48 Ratio 1000 lb drive rating
 AKM43 Motor, 16:48 Ratio 3000 lb drive rating
 AKM 53 Motor, 22:48 Ratio 6000 lb drive rating

Approved by: 

Date: November 19, 2009

SEE ATTACHED 2 DRAWINGS

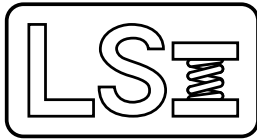

025-0000-0266-01 J

Parts List

Main Assembly UT 25-XXXX, Left Swing Door

Rev	By	Date	Description
F	KMP	02-16-2007	Change the belt winding dircetion, Update Motor Bracket and Stand-off, Items 21 was (12) 13-0-0065-00, 22 was (45), 34 was 18-0-2799-00, 35 was 7-0-0099-00, 36 was 13-0-0057-00, 42 was 11-3-0017-00, 43 was 25-1-0543-00.
G	MEL	02-11-2008	Added 050-1000-0047-00
H	SGS	06-16-2008	Chg Servo location and Belt Length
J	DAL	11-19-2009	Revised motor mount to accept 4X and 5X series motors, 018-000-3176-00 was 018-0000-1210-00

Item	Qty	Part Number	Rev	Part Name	PCB Location	Part Length
22	36	013-0000-0026-00		10-24 X 1/2 BHSCS		in.
23	1	013-5000-0216-00		Timing Belt		in.
24	Opt	011-4000-0019-00		Fan 5.0" Guard		in.
25	1	018-0000-2795-00	A	Left Side Planel, UT 25		in.
26	1	018-0000-2796-00	A	Back Side Planel, UT 25		in.
27	1	018-0000-2797-00	B	Right Side Planel, UT 25		in.
28	1	018-0000-1226-00	A	LIMIT SWITCH COVER, UT 25-2000		in.
29	1	018-0000-1199-01	C	12" dia x 5/8-18, Upper Platform, UT 25		in.
29	Ref	018-0000-1199-02	C	12" dia x 6.125 thru hole, Upper Platform, UT 25		in.
29	Ref	018-0000-1199-03	C	12" dia x 2.125 thru hole, Upper Platform, UT 25		in.
29	Ref	018-0000-1199-04	C	12" dia x .375 thru hole, Upper Platform, UT 25		in.
29	Ref	018-0000-1199-05	C	9.5" dia x 3.125 thru hole, Upper Platform, UT 25		in.
29	Ref	018-0000-1199-06	C	9.5" dia x 4.125 thru hole, Upper Platform, UT 25		in.
29	Ref	018-0000-1199-07	C	9.5" dia x 3.125 thru hole, Upper Platform, UT 25		in.
32	Opt	013-3000-0022-00		Nylon Liquid-Tight Cord Grip Fitting, Straight Dome, 1/4" NPT,		in.
33	Opt	013-3000-0041-00		Nylon Liquid-Tight Cord Grip Fitting, Straight Dome, 1/2" NPT,		in.
34	1	018-0000-2911-00	B	Switch Mount, Flash 25 Upper limit		in.
35	1	007-0000-0140-00		MICRO SWITCH , Flash 25 Upper limit		in.
36	2	013-0000-0025-00		10-24 X 1/2 SHCS		in.
37	Opt	018-0000-2810-00		Cable Gutter, UT 25		in.
38	Opt	018-0000-2810-01		Cable Gutter, UT 25		in.
39	8	013-0000-0031-00		1/4-20 X 1/2 SHCS		in.
40	Opt	018-0000-2812-00		Cable Trough Mount, UT 25		in.
42	Ref	011-3000-0018-00		S200 SERVO MOTOR DRIVE, 3 AMP LIMIT		in.
43	1	018-0000-2896-00	B	Mounting Bracket S200 SERVO MOTOR DRIVE, Flash 25		in.
44	2	013-0000-0181-00		8-32 X 1/2 SHCS		in.
45	2	018-0000-1224-00	B	Front Cover, UT 25-2000		in.
46	2	018-0000-1225-00	B	Side Covers, UT 25-2000		in.
47	ref	050-1000-0047-00		Servo Controller Setup File - FLASH 25-3000, 3 Amp, AKM41E,		in.

#10 AKM41 Motor, 16:48 Ratio 1000 lb drive rating
 AKM43 Motor, 16:48 Ratio 3000 lb drive rating
 AKM 53 Motor, 22:48 Ratio 6000 lb drive rating

Approved by: 

Date: November 19, 2009

SEE ATTACHED 2 DRAWINGS



Larson Systems Inc.
10073 Baltimore Street NE
Minneapolis, MN 55449-4425
www.larsonsystems.com

763-780-2131
1-877-780-2131
Fax: 763-780-2182
info@larsonsystems.com

